

OSW

SLIDING SYSTEM
WITH THERMAL BREAK



EPAL[®] S.A.

DOORS - WINDOWS

E50 COMBINES THE TRENDS IN MODERN ARCHITECTURE WITH THE NEEDS ARISING FROM THE STRICT STANDARDS FOR ENERGY CONSERVATION



FEATURES

$U_w = 1.5 \text{ W/m}^2\text{K}$

Robust constructions for large and medium openings

Contemporary aesthetics with straight line design

Easy operation with lift and slide mechanism

Excellent water tightness characteristics

E50

SLIDING SYSTEM
WITH THERMAL BREAK

DESIGN

DESIGNED FOR MEDIUM AND LARGE
OPENINGS

IDEAL CHOICE FOR THE MAJORITY
OF RESIDENTIAL AND COMMERCIAL
APPLICATIONS

DETAILS

Rigid and capable to operate under heavy loads

Sash frame (min depth): 50 mm

Min. height of sash: 81.5 mm

Min. height of rail: 45 mm

Max. glass thickness: 34 mm

Max. sash weight: 250 kg

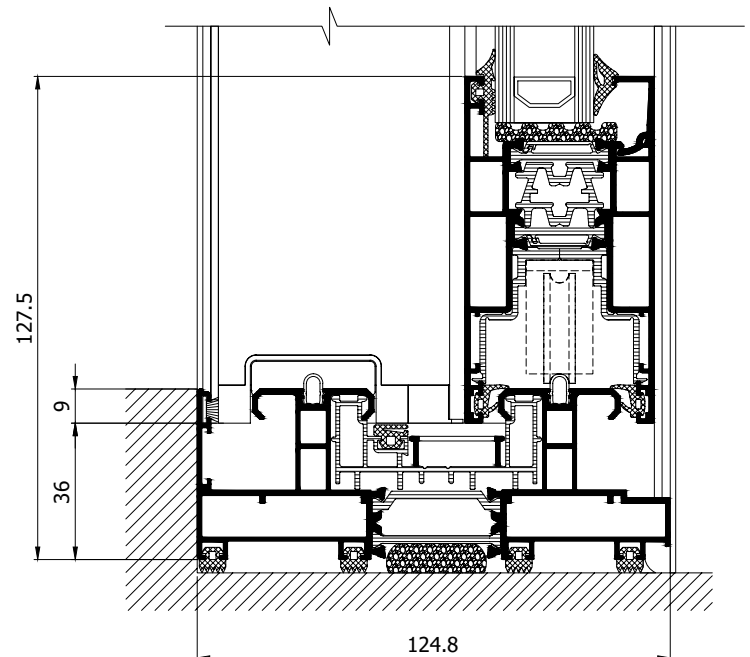

epal-windows.ca